

# INSTALLATION INSTRUCTION

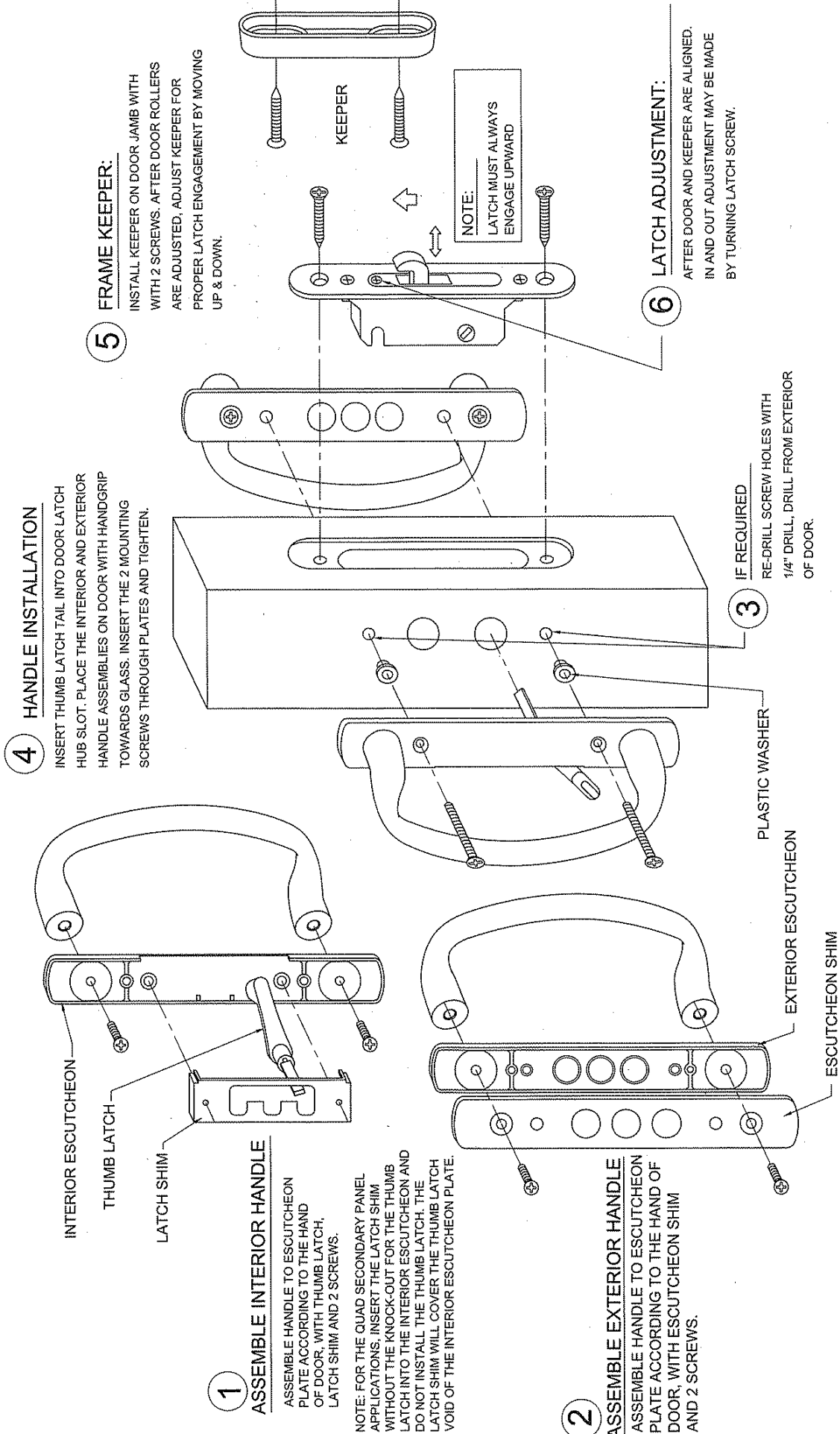

**1**

**ASSEMBLE INTERIOR HANDLE**

ASSEMBLE HANDLE TO ESCUTCHEON PLATE ACCORDING TO THE HAND OF DOOR, WITH THUMB LATCH, LATCH SHIM AND 2 SCREWS.

NOTE: FOR THE QUAD SECONDARY PANEL APPLICATIONS, INSERT THE LATCH SHIM WITHOUT THE KNOCK-OUT FOR THE THUMB LATCH INTO THE INTERIOR ESCUTCHEON AND DO NOT INSTALL THE THUMB LATCH. THE LATCH SHIM WILL COVER THE THUMB LATCH VOID OF THE INTERIOR ESCUTCHEON PLATE.

**2**

**ASSEMBLE EXTERIOR HANDLE**

ASSEMBLE HANDLE TO ESCUTCHEON PLATE ACCORDING TO THE HAND OF DOOR, WITH ESCUTCHEON SHIM AND 2 SCREWS.

**4**

**HANDLE INSTALLATION**

INSERT THUMB LATCH TAIL INTO DOOR LATCH HUB SLOT. PLACE THE INTERIOR AND EXTERIOR HANDLE ASSEMBLIES ON DOOR WITH HANDGRIP TOWARDS GLASS. INSERT THE 2 MOUNTING SCREWS THROUGH PLATES AND TIGHTEN.

**5**

**FRAME KEEPER:**

INSTALL KEEPER ON DOOR JAMB WITH WITH 2 SCREWS. AFTER DOOR ROLLERS ARE ADJUSTED, ADJUST KEEPER FOR PROPER LATCH ENGAGEMENT BY MOVING UP & DOWN.

**6**

**LATCH ADJUSTMENT:**

AFTER DOOR AND KEEPER ARE ALIGNED, IN AND OUT ADJUSTMENT MAY BE MADE BY TURNING LATCH SCREW.

**3**

**IF REQUIRED**

RE-DRILL SCREW HOLES WITH 1/4" DRILL, DRILL FROM EXTERIOR OF DOOR.

INTERIOR ESCUTCHEON

THUMB LATCH

LATCH SHIM

PLASTIC WASHER

EXTERIOR ESCUTCHEON

ESCUTCHEON SHIM

KEEPER

NOTE:  
LATCH MUST ALWAYS  
ENGAGE UPWARD